

Power Line EMI Filter

1. Type: TPF282D-63

2. Dimensions: (mm)

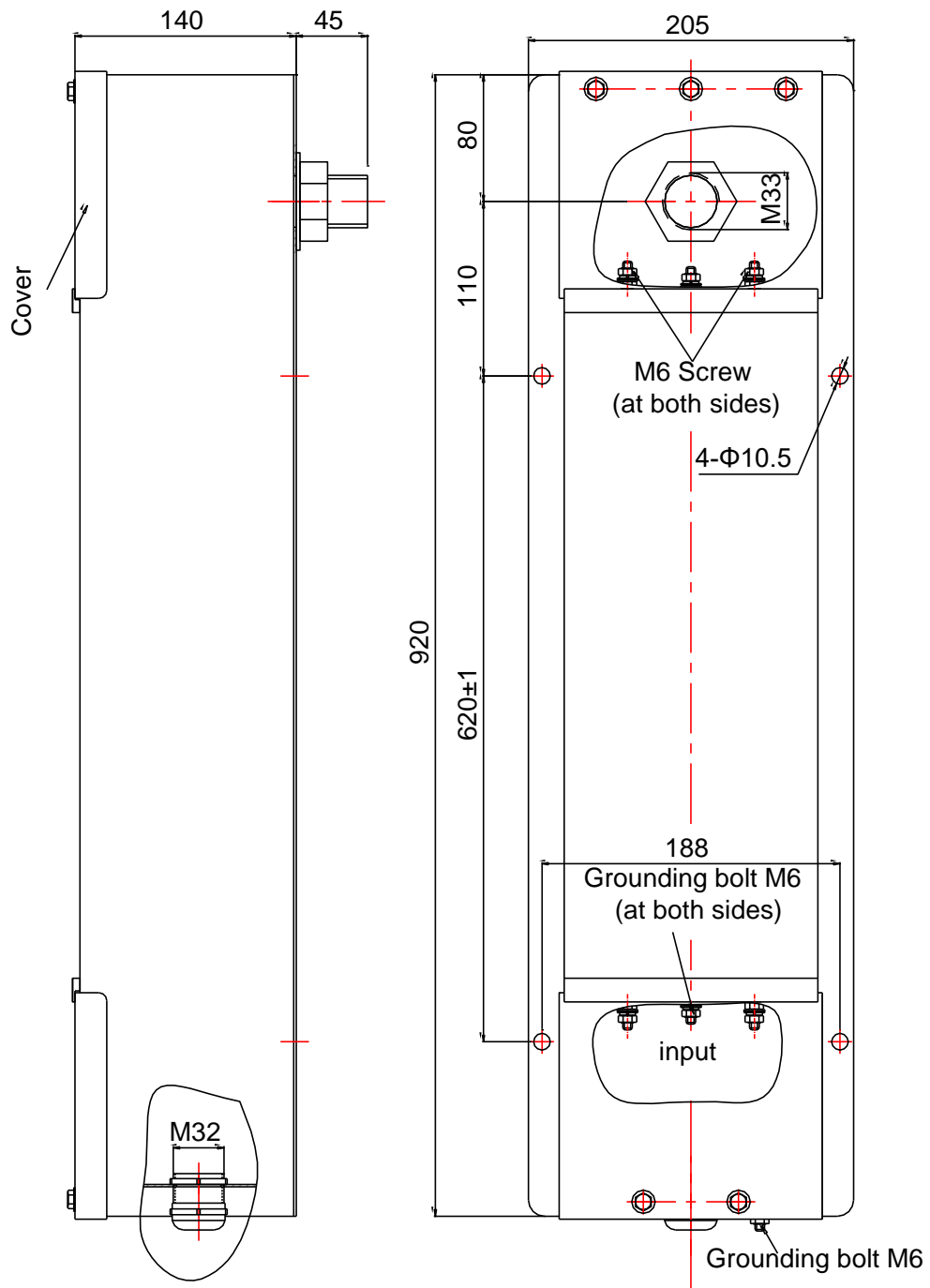

TESTUPS

3. Technical Data:

- ① Rated Voltage: 250VAC/500VDC
- ② Operating Frequency: 0-60Hz
- ③ Rated Current: 63A
- ④ Insertion Loss: 100dB, 10kHz-40GHz
- ⑤ Climatic Category: 25/085/21

4. Assembly Parts:

- ① M33 Conduit Screw: 1pc
- ② Gasket 33: 1pc
- ③ M33 Screw Nut: 1pc
- ④ EMI Gasket 33: 1pc
- ⑤ Certificate: 1pc
- ⑥ Cable Gland M32: 1pc

5. Typical Insertion Loss Performance Curve (acc. to MIL-STD-220C)

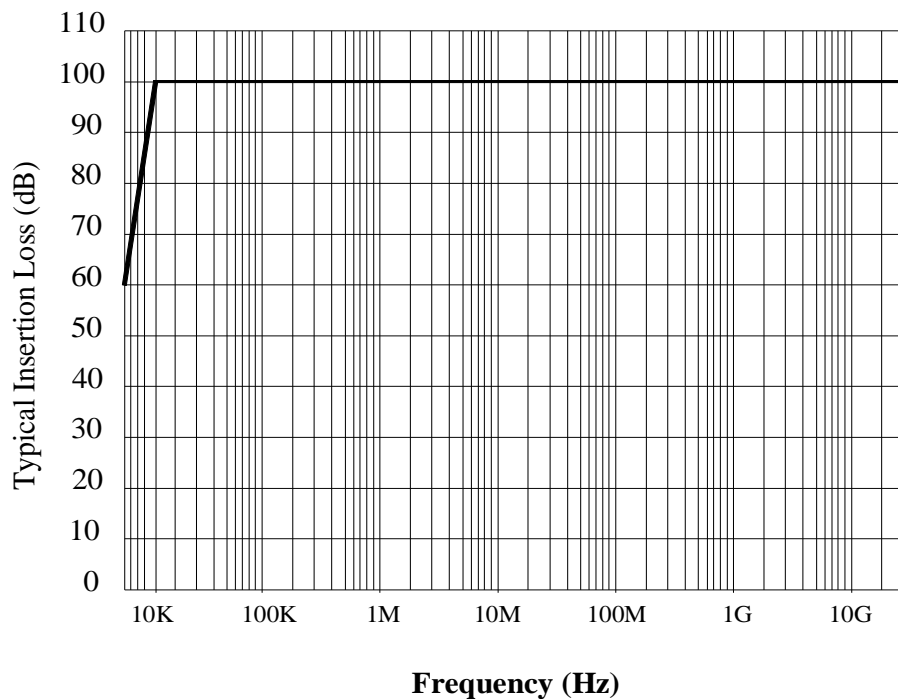

**Asymmetric Performance in 50 ohm System
With or Without load**

1) according to MIL-STD-285

6. Product in photo *TPF482C-100*



7. Installation Diagram:

