

Power Line EMI Filter

1. Type: TPF486C-63

2. Dimensions: (mm)

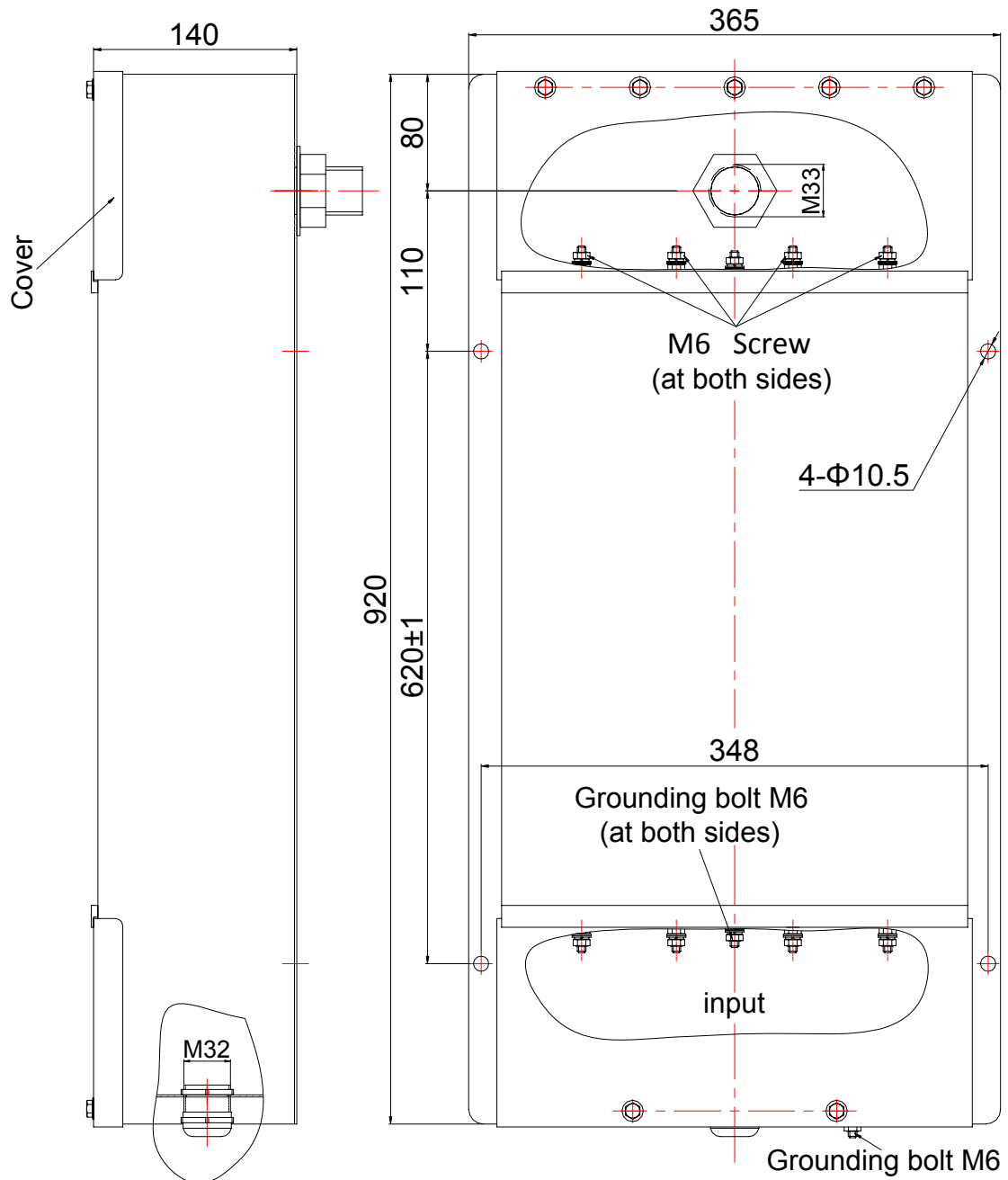

TESTUPS

3. Technical Data:

- ① Rated Voltage: 440VAC/250VAC ② Operating Frequency: 0-60Hz
- ③ Rated Current: 63A ④ Shielding Effectiveness: 100dB, 14kHz-40GHz
- ⑤ Climatic Category: 25/070/21

- ## 4. Assembly Parts:
- ① M33 Conduit Screw: 1pc ② Gasket 33: 1pc
 - ③ M33 Screw Nut: 1pc ④ EMI Gasket 33: 1pc
 - ⑤ Certificate: 1pc ⑥ Cable Gland M32: 1pc

5. Product in photo *PF482C-100*



6. Installation Diagram:

